

JaguarVoice

INTRODUCTION

JaguarVoice provides a safe and convenient way of controlling the following vehicle systems (where fitted):

- Sound system (radio, single CD player and CD changer – as applicable).
- In-car telephone.
- Climate control system (front user only unless - zone climate control is fitted).

The system is controlled by the Voice button on the left-hand side of the steering wheel.

See the illustrations on the following pages.



WARNING:

Concentrate on the current road conditions and driving the vehicle at all times. If the voice system does prompt you for a response it will repeat that prompt twice giving you up to 15 seconds to respond. If driving conditions mean that you are unable to respond, the voice system will time-out, cancel the task and will not make any changes to the vehicle settings.

Language and accent

Commands are given in English using a natural speaking voice, without pausing between words. Most accents are understood without difficulty, but the system also allows you to train the voice system with your voice if required, see 'VOICE TRAINING', page 288.

JaguarVoice

Steering wheel voice switches

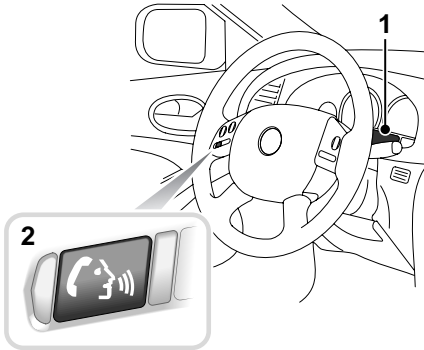

JAG0825

1. Message centre display.
2. Voice button.
3. Mode button, on radio.
4. Seek/tuning control, on radio (used to commence voice training).

USING THE SYSTEM

Initialisation

JaguarVoice is ready to operate ten seconds after the starter switch is turned to position **II**; the system is enabled.

Driver voice controls

The voice button is on the left-hand side of the steering wheel, see 'Steering wheel voice switches', page 277.

Some examples of using the system are provided on the following pages for you to try.

Note: The system will not operate until the radio security code has been entered.

JaguarVoice

First try some of these commands:

Tuning the radio

Your instructions to the system	System response
Press and release the voice button	'Beep'
After the beep say 'Radio tune 98.9 FM'	The system responds with: 'Radio tune 98.9 FM' and tunes the radio to this frequency

Now try entering a frequency of your own preference, see *'HOW TO SAY NUMBERS'*, page 283.

Storing a nametag to this station

Your instructions to the system	System response
Press and release the voice button	'Beep'
After the beep say 'Radio store name'	The system responds with: 'Radio store name, Name Please'
Press and release the voice button	'Beep'
After the beep say 'My favourite station'	The system responds with: 'My favourite station, please say yes or no'
Press and release the voice button	'Beep'
After the beep say 'Yes'	After a few seconds the system responds with: 'My favourite station stored'

Recalling the nametag you have just stored

Your instructions to the system	System response
Press and release the voice button	'Beep'
After the beep say 'Radio tune my favourite station'	The system responds with: 'Radio tune my favourite station' and tunes the radio to the frequency stored with this name

Now try storing a nametag of your choice, and then recalling it.

JaguarVoice

Entering a phone number

Your instructions to the system	System response
Press and release the voice button	'Beep'
After the beep say ' Phone enter zero one six one four '	The system responds with: 'Phone enter oh one six one four, Continue entering digits or say dial, store, correction or cancel'
Press and release the voice button	'Beep'
After the beep say ' nine six oh nine nine eight '	The system responds with: nine six oh nine nine eight, Continue entering digits or say dial, store, correction or cancel'
Press and release the voice button	'Beep'
After the beep say ' Dial '	The system responds with: 'Enter Dial'

Now try entering a phone number of your choice and try some of the following commands:

1. **DIAL**, dials the number entered.
2. **STORE**, stores a nametag of your choice (as in the above example with **Radio store name**).
3. **CORRECTION**, deletes the last string of digits entered, and allows you to re-enter them.
4. **CANCEL**, cancels the command.

Note: When entering a number of your choice, remember numbers can only be given as single digits, but you can enter the digits in as many groups as you like.

Also, when the system has read out the numbers you have entered, you do not have to wait for the 'Continue entering digits' prompt. Simply press the voice button and continue with your dialogue.

JaguarVoice

Operating tips

- After pressing the voice button, wait for the end of the single listening beep before giving the command.* 'LISTENING' will be displayed on the instrument pack.
- Face forward and speak naturally, as if you were talking to a passenger or on the phone.
- Note the structure of the commands; remember this rather than trying to remember all the commands.

Device Function Setting

 ↓ ↓ ↓

'Radio Tune 97.4'

- If you forget any of the commands, try saying 'VOICE HELP'. The system will then give you a list of help menus available, from which you can choose the appropriate one for the command you need.
- The Voice system will repeat the command back to you and display it on the message centre. The command will then be performed.
- If you hear a double beep when you give a command, press the voice button and try again.*

* A single beep denotes when the voice system is listening for a command. A double beep denotes when the system has stopped listening, due to an error or when an incorrect command has been given.

Command confirmation

After a command has been given, the system will give feedback of what it understood. The verbal feedback can be switched on or off by saying 'VOICE FEEDBACK ON' or 'VOICE FEEDBACK OFF'. Verbal feedback for help commands, directory listings, prompts, error messages and nametags cannot be switched off.

For the 'PHONE DIAL' commands, the system will prompt for confirmation before making the call. This confirmation can be switched on or off by saying 'PHONE CONFIRMATION ON' or 'PHONE CONFIRMATION OFF.'

For each voice command there is an associated visual confirmation, which is shown on the front instrument pack.

Voice system prompts

During some commands and for voice training, you will be asked by the system for a reply. In such cases you must press and release the voice button then speak after the beep. The system will remind you twice so don't worry about having to respond to the system immediately.

JaguarVoice

Nametags

Nametags are a unique name or phrase of your choice which can be used to recall a radio station or dial a phone number.

For radio commands, 'PHONE DIAL <nametag>' is used to select a station that has been previously stored using the 'RADIO STORE NAME' command.

For phone commands, 'RADIO TUNE <nametag>' is used to dial a phone number that has been previously stored using the 'PHONE ENTER' or 'PHONE STORE' command. Phone numbers held in the voice system memory are quite separate from numbers held in the phone system memory (To call a number held in the phone memory, use the 'PHONE DIAL MEMORY <number>' command).

A spoken list of current nametags can be heard by giving the appropriate directory command.

- 'RADIO DIRECTORY'
- 'PHONE DIRECTORY'

There are also commands for deleting either individual names in a directory, or a complete directory, see '*VOICE COMMAND LIST*', page 284.

Hints on storing nametags

- You will have greater success of recalling, and remembering, nametags of two, three, or four words in length. Although nametags of one word in length are also acceptable.
- For best results, store nametags in a quiet environment, i.e. with the windows and sunroof closed, try not to be travelling at speeds above 100 km/h (60 mph), and ask other occupants to be quiet.
- Try not to store a nametag that sounds similar to a nametag already stored, or to any of the commands recognized by the system.

In addition, for phone nametags, do not use numbers, and for radio nametags, try not to use radio frequencies.

Volume level adjustment

The verbal feedback volume level can be adjusted independently for the JaguarVoice system. To adjust, operate the sound system volume control or the steering wheel volume control whilst the voice system is being used. The speaker volume level can also be adjusted within the volume preset menu of the audio system.

JaguarVoice

Some useful notes:

- Only one person at a time can use the voice system.
- Excessive noise, for example while driving with windows open or in demist mode, may cause voice command misrecognition. If it is too noisy to use the phone, it is likely that voice commands will not be recognised.
- Voice commands cannot be given while a hands-free phone call or radio traffic announcement is in progress.
- If the voice button is pressed whilst a radio traffic announcement is in progress, the announcement will be cancelled. Press the voice button again to start a voice session.
- While 'LISTENING' is displayed on the message centre, the command can be cancelled by pressing the same voice button that was used to start the voice session, except when using the 'PHONE ENTER' command. To cancel a 'PHONE ENTER' voice session either say 'CANCEL' when 'LISTENING' is displayed or press the voice button and after the end of the beep say 'CANCEL'. During a store nametag session, if the voice button is pressed and released during 'LISTENING', the system will cancel after up to two seconds.
- Voice feedback can be interrupted by pressing the voice button that was used to start the voice session, whilst the feedback is playing.
- After starting to speak, the command must be completed within ten seconds.
- During a voice command the audio system and direction indicator ticking will be muted.
- The voice session will be cancelled if an alternative message requires the display/speaker (e.g. incoming phone call or radio traffic announcement).

JaguarVoice

HOW TO SAY NUMBERS

Numbers in voice commands must be given as shown below. Either 'zero' or 'oh' can be used for '0', most users will find that 'zero' gives better results. For information about specific commands, see 'VOICE COMMAND LIST', page 284.

Radio stations

Frequencies are said as in the following examples:

- 'Tune five thirty one AM', or 'Tune five thirty one' (531).
- 'Tune nine hundred' (900).
- 'Tune fourteen forty' (1440).
- 'Tune fifteen oh three AM' (1503).
- 'Tune ten eighty' (1080).
- 'Tune eighty nine point nine FM' or 'Tune eighty nine point nine' (89.9).
- 'Tune ninety point zero' or 'Tune ninety' (90.0).
- 'Tune one hundred point five' (100.5)
- 'Tune one oh one point one FM' (101.1).
- 'Tune one oh eight point oh', 'Tune one oh eight point zero', or 'Tune one oh eight' (108.0).

Disc and track numbers

For CD commands, say disc and track numbers as in the following examples:

- 'Disc one' (1).
- 'Disc six track ten' (6, 10).
- 'Track twenty five' (25).
- 'Track forty seven' (47).

Phone numbers

All phone numbers are said as single digits, as in the following example. Double, Triple and Treble are also acceptable commands if preceding a single digit. Plus (+), Star (*) and Hash (#) are acceptable as the first digit of a number.

- 'Dial zero one two zero three four zero two one double four' (01203 402144).

When using the Phone Enter command, the first entry must be between 2 – 16 digits, then, 1 – 16 digits to a maximum of 32 in total.

Temperatures

In climate control commands, say temperatures as in the following examples:

- 'Temperature seventy two' (72).
- 'Temperature eighty' (80).
- 'Temperature twenty one point five' (21.5).
- 'Temperature nineteen point zero', 'Temperature nineteen point oh' or 'Temperature nineteen' (19.0).

JaguarVoice

VOICE COMMAND LIST

Certain commands are only available to the driver, these are indicated in the following list.

Key

() denotes an option, i.e. (ON/OFF) use either ON or OFF with this command.

< > indicates where to say a number or stored nametag.

[] denotes an optional word, e.g. 'VOICE [PLAY] DIRECTORY' can be given as 'VOICE DIRECTORY', or 'VOICE PLAY DIRECTORY'.

(front use only) – indicates this command is not available to rear occupants.

General commands

- HELP
- VOICE HELP
Lists all voice command help messages available.
- VOICE MEMORY HELP (front use only)
- VOICE FEEDBACK (ON/OFF)
- PHONE CONFIRMATION (ON/OFF)
Switches on or off the system confirmation prompt before making a call when using the PHONE DIAL or PHONE MEMORY DIAL command.
- VOICE [PLAY] DIRECTORY (front use only)
- VOICE DELETE MEMORY (A/B) (front use only)
- VOICE DELETE DIRECTORY (front use only).

JaguarVoice

Radio commands

- RADIO PLAY or RADIO ON
Turns the sound system on.
- RADIO OFF
Turns the sound system off. Use this command to turn off the CD or CD changer.
- RADIO SEEK [UP]
- RADIO SEEK DOWN
- RADIO TUNE <frequency> [MEDIUM WAVE/LONG WAVE/FM]
Tunes to the frequency given in the command.
See 'HOW TO SAY NUMBERS', page 283.
(The radio will not respond to Long Wave commands in Australia and New Zealand.)
- RADIO TUNE <nametag>
- [RADIO] [TUNE] PRESET <preset number>
Selects the stored station corresponding to the preset number (1 to 9) given in the command.
- [RADIO] [TUNE] [BAND] (MEDIUM WAVE/LONG WAVE/FM)
- RADIO TRAFFIC INFO (ON/OFF)
Turns on or off the Traffic Announcement (TA) feature.
- RADIO STORE NAME
Stores the currently selected station, with a nametag of your choice. See 'Storing a nametag to this station', page 278. A total of 20 nametags can be stored.

- [RADIO] STORE PRESET <preset number>
Stores the currently selected station to the preset given in the command.
Note: The sound system must be in radio mode before giving the 'RADIO STORE NAME' or 'RADIO STORE PRESET' command.
- RADIO AUTOSTORE
- RADIO DELETE <nametag>
- RADIO DELETE DIRECTORY
Deletes all currently stored radio nametags.
- RADIO [PLAY] DIRECTORY
- RADIO HELP
- RADIO MEMORY HELP

Single CD commands (where fitted)

- CD PLAY or CD ON
- CD [PLAY] TRACK <track number>
See 'HOW TO SAY NUMBERS', page 283.
- CD MIX TRACKS
This will play the tracks of the current disc in a random order.
- CD MIX OFF
- CD HELP

CD changer commands (where fitted)

- CHANGER PLAY or CHANGER ON
- [CHANGER] [PLAY] DISC <disc number>
- [CHANGER] [PLAY] TRACK <track number>
See 'HOW TO SAY NUMBERS', page 283.
- [CHANGER] [PLAY] DISC <disc number> TRACK <track number>

JaguarVoice

- CHANGER MIX TRACKS

This will play the tracks of the current disc in a random order.

- CHANGER MIX ALL

This will play all the tracks and discs within the CD changer in a random order.

- CHANGER MIX OFF

- CHANGER HELP

Generic track commands

These commands play the current or previous CD, MD or Changer.

- [PLAY] TRACK <track number>
- MIX TRACKS
- MIX OFF

Phone commands (where fitted)

Note: In noisy conditions, for example, in heavy rain or driving at high speed on a rough road surface, use the 'PHONE ENTER' command, entering the number in several groups for improved recognition.

- PHONE (ON/OFF)
- [PHONE] ENTER <2 – 16 phone digits>

See 'HOW TO SAY NUMBERS', page 283.

The system responds to this command by repeating the phone number back to you and then giving you the options below.

Remember to press the voice button to continue with one of the options.

– <more digits>

– DIAL

– STORE (give a *nametag* when prompted as in RADIO STORE NAME, see 'Storing a *nametag* to this station', page 278.

– CORRECTION

– CANCEL

For help, see 'Entering a phone number', page 279.

A total of 40 *nametags* can be stored.

- (PHONE DIAL/DIAL) <phone number>
See 'HOW TO SAY NUMBERS', page 283.
- [PHONE] REDIAL
- [PHONE] DIAL <*nametag*>

Calls the phone number stored with the *nametag* given.

JaguarVoice

- [PHONE] DIAL MEMORY <memory location number>
Calls the phone number stored in the phone memory location given.
See 'HOW TO SAY NUMBERS', page 283.
Memory numbers 1 – 100 refer to numbers stored in the phone memory and numbers 101 – 249 are numbers stored in the SIM card.
- PHONE STORE <phone number>
Allows you to store a nametag to the number given in the command.
The system will prompt you with 'NAME PLEASE', press and release the voice button and give a nametag of your choice, as in the RADIO STORE NAME. See 'Storing a nametag to this station', page 278.
A total of 40 phone nametags can be stored.
See 'HOW TO SAY NUMBERS', page 283.
See 'Nametags', page 281.
- PHONE [PLAY] DIRECTORY
- PHONE DELETE <nametag>
- PHONE DELETE DIRECTORY
Deletes all currently stored phone nametags.
This does not affect numbers stored in the phone memory.
- PHONE CONFIRMATION (ON/OFF)
- PHONE HELP
- PHONE MEMORY HELP

Note:

- When an outgoing phone call is terminated, the sound system will remain in phone mode. To change to another mode, give the appropriate voice command.
- The voice system is inactive while a phone call is in progress.

Automatic climate control commands

- CLIMATE CONTROL ON
- CLIMATE CONTROL OFF
- [CLIMATE CONTROL] AUTOMATIC [ON]
- [CLIMATE CONTROL] TEMPERATURE <temperature> [DEGREES]
The temperature can be given in Celsius or Fahrenheit, in the range 17 to 31 degrees Celsius (61 to 89 degrees Fahrenheit), in increments of 0.5 degree Celsius (1.0 degree Fahrenheit).
See 'HOW TO SAY NUMBERS', page 283.
Note: Do not say the word 'Celsius' or 'Fahrenheit'.
- [CLIMATE CONTROL] TEMPERATURE (HIGH/LOW) (front use only)
- [CLIMATE CONTROL] RECIRC [ON] (front use only)
Recirculation mode, see 'AIR RECIRCULATION', page 153.
This command will not be executed if the climate control system is in defrost mode.

JaguarVoice

Automatic climate control commands (continued)

- [CLIMATE CONTROL] BALANCE [ON]
When the driver gives this command the temperature of all zones are set to the same as the driver's side temperature. When a rear occupant gives this command the temperature of both rear zones will be set to the same.
- [CLIMATE CONTROL] DEFROST [ON] (front use only).
- CLIMATE CONTROL HELP.
- REAR CLIMATE CONTROL OFF.
- [CLIMATE CONTROL] RECIRC [ON]
Switches the climate control system to recirc mode. This command will be disabled if the climate control system is in defrost mode.

VOICE TRAINING

The voice system is able to interpret most English speakers without difficulty. If, however, you find that commands are sometimes not being recognised, you can train the voice system to recognise your voice. The voice system can be trained for two people using voice memories A and B.

After Voice Training, the system will automatically recognise the users whose voices are held in the voice memory. The system can still be used by other users, with no loss of recognition.

Training procedure

Training can only be carried out whilst sitting in the driver's seat.

Give the command 'VOICE DIRECTORY', this will list the memories used and tell you if they are stored with a nametag.

If no memories are in use, either memory can be used.

If both memories are in use and you wish to overwrite one of the memories, select the memory you wish to overwrite.

- First, select which voice memory to train.
- Position the vehicle, with the sunroof and windows closed, in a reasonably quiet outdoor location.
- Sit in the driving seat with the engine running, the handbrake or Electric Parking Brake (EPB) on and the transmission in Park or Neutral.

JaguarVoice

- Press and release the MODE button on the radio (adjacent to the volume control). Mode level 1 will display. Press the MODE button repeatedly until 'ADV MODE N/Y' is displayed. Turn the volume control to select 'ADV MODE YES' Press the MODE button repeatedly until 'VOICE A' is displayed. To select 'VOICE B' press the MODE button again.
- With 'VOICE A' or 'VOICE B' displayed on the radio press the seek up control to start Voice Training. Once you have selected which memory to use, the system gives verbal instructions about the training procedure.
- Follow the instructions given by the system. See '*TRAINING COMMAND LIST*', page 290.
- To cancel Voice Training at any time press and hold the voice button for five seconds.

Note:

- *Some of the phrases which the voice system asks you to repeat during voice training are not valid voice commands, these are used to collect specific phonetic phrases required by the system.*
- *If the user does not speak after a phrase prompt, the voice system will provide two reminder prompts then cancel Voice Training.*
- *The voice system turns off the phone whilst in training mode, so it will need to be turned on manually after Voice Training has finished.*

JaguarVoice

TRAINING COMMAND LIST

The 'sounds' of the following training commands are required for the voice system to 'learn', although some of the equipment (TV, navigation, telephone etc.) stated in the commands may not be fitted to a particular vehicle.

1. display select twilight colours
2. prefer toll roads
3. radio ten oh eight AM
4. store preset five
5. tune one oh five point two FM
6. telephone enter eight four six three seven
7. select one zero four point nine
8. CD changer play disc one track seventy six
9. climate temperature twenty five point oh degrees
10. radio one oh eight point zero
11. phone enter triple three treble zero
12. map traffic information off
13. voice guidance on
14. dial memory two hundred
15. teletext page eight four seven
16. radio tune thirteen ninety five AM
17. select fifteen eighty four medium wave
18. changer play CD six track sixty nine
19. navigation select zoom level eleven
20. telephone dial memory fifty two
21. climate control balance on
22. avoid major roads
23. map show complete route
24. navigation clear next waypoint
25. radio tune one oh seven point one FM
26. screen select automatic colours
27. repeat last instruction
28. phone enter gate double three one oh
29. TV channel down
30. television seek up
31. radio tune two sixteen long wave
32. select twelve thirty three medium wave
33. voice delete memory A
34. climate control seventeen point zero degrees
35. navigation show current position
36. CD changer play CD two track nineteen
37. map zoom out maximum

JaguarVoice

TROUBLESHOOTING ERROR MESSAGES

In addition to the voice command prompts given by the system, the following error messages may be displayed on the instrument pack display. Most of these messages are accompanied by an advisory double beep.

Voice Command Group	Message	Meaning
General	VOICE NOT READY	The voice system is initialising (when the starter switch is first turned on). It takes the voice system approximately ten seconds to initialise.
	NO SPEECH DETECTED	<p>The voice system has not heard any speech.</p> <ul style="list-style-type: none">• Ensure that the command is given after the end of the beep.• Ensure that the command is given within a maximum of five seconds from the end of the beep. <p>Note: Be sure you know what to say before pressing the Voice button.</p> <p>If this error is displayed for all commands given this may indicate a fault with the microphone or microphone wiring, consult your Jaguar Dealer/ Authorised Repairer for assistance.</p>
	COMMAND CANCELLED	Displayed if the user cancels a voice session during the LISTENING period or another system interrupts the voice session (i.e. incoming phone call or radio traffic announcement).

JaguarVoice

Voice Command Group	Message	Meaning
General (continued)	COMMAND NOT RECOGNISED	<p>The voice system has failed to recognise your command.</p> <ul style="list-style-type: none"> • Ensure that the command format is valid, see 'VOICE COMMAND LIST', page 284. • Ensure that the command is given after the end of the beep. • Look forward and speak clearly without pausing between words and at a level appropriate to the ambient noise level; imagine you are making a hands-free phone call. • Ensure that the ambient noise level is not excessive, for example, windows open or demist on. <p>Note: <i>If it is too noisy to use the phone, it is likely that voice commands will not be recognised.</i></p> <ul style="list-style-type: none"> • If optional words of the command have been omitted, then the command should be tried with these in place. • If a number of commands have been given in rapid succession resulting in the message 'COMMAND NOT RECOGNISED' to be displayed, then allow the system to recover (approximately one minute) before trying the command again. • If the system consistently fails to recognise commands, the voice training procedure should be carried out to improve the recognition response for the speaker.

JaguarVoice

Voice Command Group	Message	Meaning
Phone	CONNECT PHONE TRY AGAIN	If the GSM phone is in its cradle but the voice system keeps saying 'dial not accepted, please connect phone and try again', then the phone handset may not be correctly attached to its storage cradle. Try re-attaching the phone handset. If the problem persists, the phone may be incorrectly reporting its cradle status. Try powering the phone handset off and on to resolve the issue.
Voice Training	SET HANDBRAKE TO CONTINUE	This text message is displayed with its associated verbal feedback when the EPB is released during voice training. To continue voice training the brake must be re-applied.
	VOICE TRAINING UNSUCCESSFUL	This text message is displayed with its associated verbal feedback if the voice system could not save the training model recorded. If this problem occurs, please turn the starter switch off, wait five seconds, and turn the starter switch back on. Please check that there is no abnormal/excessive noise entering the vehicle interior and try running the voice training procedure again. If the voice system continues to exhibit this error, consult your Jaguar Dealer for assistance.

JaguarVoice

Voice Command Group	Message	Meaning
Nametags	RADIO NOT IN TUNER MODE	Displayed when the user tries to store a radio nametag and the radio has not been placed in tuner mode, for example playing a CD.
	NAMES TOO MUCH ALIKE	<ul style="list-style-type: none"> • This response will be received when storing a nametag if the nametag being given has already been stored. This can be confirmed by giving the RADIO DIRECTORY or PHONE DIRECTORY command. • If this response is received and the nametag has not been used already, then it is too similar to an existing nametag or voice grammar and an alternative should be used.
	SPOKE DURING LISTENING TONE	Displayed when user utters a radio or phone nametag while the beep is playing. Please wait for the end of the beep then say the nametag.
	DIRECTORY FULL	The user has tried to add a nametag to a directory that is full. The voice system can store up to 40 phone and 20 radio nametags.
	DIRECTORY EMPTY	Displayed when a RADIO DIRECTORY, PHONE DIRECTORY or VOICE DIRECTORY command is given and no nametags have been stored in the associated directory.
	NAMETAG TOO LONG	The nametag given is too short (so as not to mistake the nametag for inadvertent noise). If you experience this error please provide a longer nametag.
	STORE CANCELLED	Displayed and associated verbal response is provided when a nametag storage session is cancelled by the user.

JaguarVoice

Voice Command Group	Message	Meaning
Nametags (continued)	STORE FAILED	Displayed when the voice system fails to store a nametag. Possible reasons could be that the nametag is too long or there is too much noise. Try the command again. If the error persists, try storing the nametag under quiet conditions such as with the vehicle parked and the windows closed.

Index

Address book	273	Bulb renewal	179
Airbag service information.	65	front direction indicator	181
Airbags	60	front fog lamp.	182
Alarms and audible signals	54	front parking side lamp	181
Alternator.	206	headlamp dip beam	180
Anti-freeze	204	headlamp main beam	179
Anti-lock braking system (ABS).	134	high-mounted stop lamp	184
Audible warnings.	101	number plate lamp.	182
Audio system		rear lamp - estate.	183
audio setup	247	rear lamp - saloon	182
CD changer	253	side repeater indicator lamp	180
CD control	250	Call volume	257
change audio source.	248	Catalytic converters	147
digital signal processing	248	Changing a phone number	272
radio data systems (RDS)	236	Checking and top-up.	198
radio operation	246	clutch/brake fluid	201
single CD player operation	250	engine coolant	203
steering wheel controls	235	engine oil	198
Automatic climate control with LCD		power steering fluid	200
screen	152	windscreen washer fluid	202
Automatic transmission.	131	Child and infant safety	66
gear selector positions	131	Child safety	66
gearshift interlock	131	check list - ISOFIX	75
kickdown.	132	child restraints securing.	69
limp-home mode	132	ISOFIX child restraint system.	71
Auxiliary heater	150	ISOFIX restraint system	72
Battery		seating positioning.	68
charging	207	top tether anchorage	73
lead disconnect/reconnect	55	Child safety locks.	51
warnings	205		
Bluetooth description	257		
Bonnet release	195		
Brakes	134		
emergency brake assist (EBA)	135		

Index

Climate control		Door locks and handles	47
general points	149	smart locking	47
recommended operation	149	Door window operation	85
touch-screen		DTMF tones	272
air conditioning	162	Dynamic stability control	136
AUTO mode	158	Electric window operation	85
blower mute	162	Electrical accessories	218
blower speed	162	Emergency brake assist	135
Celsius/Fahrenheit selection	159	Emergency starting	166
climate options	164	Engine block heater	204
controls	157	Engine number	39
displays	158	Exterior lighting	110
dual temperature zones	159	auto headlamp levelling	112
external temperature	159	daylight running lamps	111
heated screens and mirrors	161	direction indicators	113
latched air recirculation	160	hazard warning	113
manual air distribution	162	headlamp convenience	110
ram air	163	headlamp levelling	112
smog sensing	164	rear fog lamps	111
switching off	163	Fire extinguisher	138, 193
temperature selection	159	First aid kit	138
timed air recirculation	160	Floor mat retention	34
windscreen defrost/demist	161	Foreign travel	138
Clock	82	Fuel and refuelling	142
Clock setting	241	Fuel capacity	143
Compact disc changer		Fuel consumption	226
CD check sequence	253	Fuel requirements	144
CD selection	254	diesel engines	145
CDC button	254	petrol engines	144
display panel	254	Fuel tank filling	142
loading discs into the magazine	253	Fuses and fuse boxes	185
mix	254	fuse box locations	186
operation	253	fuse renewing	185
pause	255	General driving information	137
repeat	255	engine braking	137
seek up and down	254	engine oil consumption	138, 196
Declaration of conformity	275	parking the vehicle	137
Diesel		running-in	38
auxiliary heater	150	use of headlamps	137
Diesel engines		warming up	137
running out of fuel	147	General information	233
Diesel particulate filter	146	Generator	206
regeneration	146		

Index

Handbrake	124	JaguarVoice	
Hazard warning	113	command confirmation	280
Headlamp adjustment	112	command list	284
Health and safety	40	how to say numbers	283
Horn	119	introduction	276
Inertia switch	165	language and accent	276
Instruments	94	nametags	281
engine temperature	95	operating tips	280
fuel level gauge	94	steering wheel voice switch	277
odometer	95	training	
speedometer	94	training command list	290
tachometer	94	training procedure	288
Interior features	125	trouble-shooting error messages	291
cigar lighter and ashtray	127	useful notes	282
cubby box	125	using the system	277
glove compartment	126	voice system prompts	280
rear centre armrest	128	volume level adjustment	281
sliding armrest	125	Key transmitter	44
sun visors	128	battery replacement	46
Interior lighting		Keys	43
battery saver	114	Lighting	
dimmer switch	115	Exterior	110
entry/exit	114	Locking wheel nuts	171
reading/map lamps	114	Luggage compartment	90
rear roof lamp	114	estate luggage cover	92
Introduction		estate luggage load net	93
audio systems	228	tie-down loops, saloon	90
automatic climate control	227	wagon luggage load net	93
in-car telephone	228	Maintenance	194
JaguarVoice	228	general precautions	194
screen cleaning	227	protect the environment	194
Jacking	169	regular checks	196
Jaguar parts and accessories	33	regular servicing	194
		Manual transmission	133
		Message centre	102
		messages	103
		Mirrors	
		door	88
		electrochromic	89
		heating	88
		interior rear view	89
		power fold back	88

Index

Mobile/portable telephones	34	Seat heaters	81
Occupancy sensing	63	Security code number	233
Occupant restraints	60	Security features	54
Owner general information	32	battery reconnection	55
Pairing	261	inclination (tilt) sensing	55
Parking assist	116	intrusion sensing	55
Phone book	273	panic alarm	55
Protect the environment	34	Single CD player	
Radio		CD button	250
auto memory	244, 249	display panel	250
automatic volume control	241	eject and CD-in indicator	250
band switch	243	mix	250
change audio source	243	repeat	250
digital signal processing	242	seek up and down	250
display panel	241	Sitting in the correct position	76
mode level 1	241	Sport mode	132
ON/OFF and volume	241	Starter switch	42
presetting memorised stations	243	gearshift interlock	42
priority programme type (PPTY)	238	steering column lock	42
programme type (PTY)	238	to remove the key	42
RDS operation	237	Starting/stopping the vehicle	129
RDS trouble-shooting guide	240	before starting	129
reception	236	starting a diesel engine	130
seek and manual tuning	243	starting a petrol engine	129
source tone memory	243	Steering column adjustment	84
TA operation	238	Steering wheel controls	260
Radio frequency approval	45	Sunroof	120
Radio set up	244	Telephone	257
Rain sensitive wiper control	121	PIN	272
Rear seat back fold down	91	Safety	258
Regular checks	196	Standard	264
Regular servicing	36	Making a call	266
Reverse aid	116	Memory recall dialling	267
Roof-rack	139	Multizone voice	267
Roof-rack		Receiving a call	266
capacity	223	Rejecting a call	266
Running-in	38	System overview	257
Seat adjustment	76	Touch-screen	268
front seats - electrical	78	Making a call	268
front seats - electrical with memory	80	Multizone voice	271
head restraints	77	Receiving a call	269
Seat belts	56	Temporary spare wheel	170
		Touch-screen	227

Index

Touch-screen controls		
Last number redial	269	
List by name	271	
Location number	270	
Name entry	271	
Touch-screen display	229	
brightness/contrast	231	
menu	230	
system setup	231	
volume preset	230	
Touring	138	
Touring headlamp adjustment	112	
Towbar fixing points	141	
Towing a caravan or trailer	139	
Towing a trailer	139	
Towing eye	177	
Trailer weights	223	
Tyres	210	
damage	213	
pressures	211	
recommended fitment	225	
renewal	210	
repair	213	
snow chains	214	
wear	213	
winter (snow) tyres	214	
Vehicle		
recovery	175	
transporting	176	
Vehicle care	215	
alloy road wheels	217	
automatic car wash	216	
carpets	215	
cloth upholstery	215	
exterior care	216	
glass surfaces	216	
interior care	215	
leather upholstery	35	
paintwork	217	
removing grease or tar	216	
removing stains	215	
underbonnet cleaning	217	
washing	216	
Vehicle data		
dimensions	224	
engine	219	
recommended tyre fitment	225	
roof load and trailer weights	223	
weights	220	
Vehicle identification	39	
Vehicle locking and unlocking	47	
Vehicle recovery	175	
towing eye	177	
transporting	176	
Vehicle security	43	
alarms and audible signals	54	
child safety locks	51	
door locks and handles	47	
key transmitter	44	
keys	43	
luggage compartment	52	
security light	43	
Voice activation	258	
Volume	257	
Warning indicators	96	
Warning triangle	139	
Warnings, cautions and notes	32	
Weights	220	
Wheel changing	171	
Wheel changing and jacking	169	
Wheel/tyre data	225	
Wind resonance	86	
Window operation	85	
anti-trap feature	87	
Window tinting	34	
Windscreen		
wipers/washers	121	
Winter driving	138	
Wiper blades	209	